

# Pulsante Luminoso / Illuminated Pushbutton PL-SB35

Scheda – Data sheet

Rev. 1.01

## PL-SB35 Scheda tecnica / Data sheet



**PL-SB35**

Standard basso profilo con dado, rettangolo 35  
Low profile standard lock nut mount, rectangle 35

### Caratteristiche funzionali / Functional features

Fabbricato in solido policarbonato.  
Disponibile con piastrino bianco e lente trasparente.  
Cornice nera, o cromata.

Attacco a baionetta brevettato: solidità di tenuta, rapidità di montaggio e rimozione.

Retro-illuminazione:  
- a lampadina: 12V o 24 V.  
- a LED: 12V.

Made out of sturdy polycarbonate.  
Label plate in white; clear lens.  
Outer frame in black, or chrome.

Alberici patented Twist-on coupling provides tightness as well as fast fitting.

Back-lighted by:  
- light-bulb 12V or 24V.  
- LED: 12V.

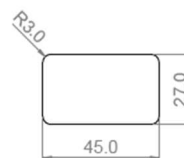
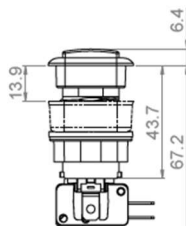
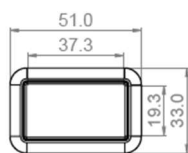

Pannello di montaggio Mounting template

### OPZIONI - OPTIONS

PM-S212-2B00 (1-LED)/ PM-S212-5B00 (5-LED)

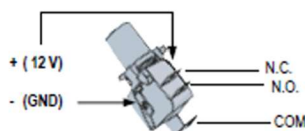

#### PIN OUT

PM-S212-2B00 (1-LED)  
PM-S212-5B00 (5-LED)



1 LED  
T10 Light source



5 LED  
T10 Light source

#### ILLUMINATION OPTIONS

##### 1-LED

Voltage: 12V  
Current: 20mA  
Power: 0,25W  
K° = 8.000

##### 5-LED

Voltage: 12V  
Current: 40mA  
Power: 0,50W  
K° = 8.000

Lifecycle: 50.000 oper.



Via Ca' Bianca 421  
40024 Castel San Pietro  
Terme (BO) – ITALY

Progettazione e produzione di sistemi di pagamento, accessori per videogames e macchine vending Design and manufacture of payment systems, accessories for videogames and

Tel. + 39 051 944 300  
Fax. + 39 051 944 594

<http://www.alberici.net>

[info@alberici.net](mailto:info@alberici.net)